

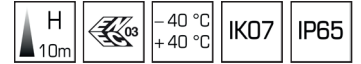

# Formula65 / High / Extreme

**High protection class emergency luminaire:** High protection class exit sign luminaire: Casing with convex light-emitting surface and clear cover with click fasteners. Lighting control is provided by a plastic reflector. The Formula65 High and Extreme version comes with M26 cable entries. The Formula65 Extreme version comes with integrated heating so that it can also be used outdoors at ambient temperatures from -40°C to +40°C.

Versions for surface wall mounting and surface ceiling mounting or with additional accessories for recessed wall mounting (solid walls), recessed ceiling mounting (hollow ceilings) and wire or rod suspension mounting.



Mounting types



Mounting types with accessories



## Technical data

Mounting options: surface or recessed wall mounting, surface or recessed ceiling mounting, suspension

Body: polycarbonate, white (RAL 9003)

Cover: polycarbonate, clear

Reflector: polycarbonate, white

Display pane: methacrylate, printed

## Decentralized supply

Protection class: III

Mains supply:  
24 V +/- 20% DC

Battery supply:  
24 V +/- 20% DC

Ambient temperature:  
-10 to +40 °C

## Central supply

Protection class: II

Mains supply:  
198V-254V/50Hz

Battery supply:  
EVG: 110V - 276V  
Sleb/Alög: 176V - 276V

Ambient temperature:  
-10 to +40 °C

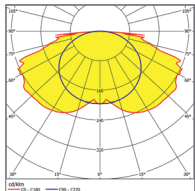

## Decentralized / Central supply

<b>SICURO</b> S24	[EVG]	[SLEB]	[ALOG]	LED	P	Φ	P =	S ~	P =
-------------------	-------	--------	--------	-----	---	---	-----	-----	-----

Surface wall mounting, surface ceiling mounting<sup>1</sup>

<b>TB16025-S24</b>	<b>TB16023</b>	<b>TB16024</b>	<b>TB16025</b>	12	3,2 W	550 lm	4,3W	11,0 VA / 6,4 W
--------------------	----------------	----------------	----------------	----	-------	--------	------	-----------------

<sup>1</sup> For recessed wall or ceiling mounting in cavity walls or hollow ceilings or suspension, bracket mounting please order required accessories separately.

**Please order mounting accessories separately**

Order code	Description
<b>F95943</b>	Adaptor for suspension suspension
<b>F95600</b>	Rectangular suspension: 250 mm
<b>F95601</b>	Rectangular suspension: 500 mm
<b>F95602</b>	Rectangular suspension: 1000 mm
<b>F95401</b>	Wire suspension: max. 1200 mm
<b>FB19040</b>	Box for recessed mounting for solid wall or ceiling
<b>FB19048</b>	Box for recessed mounting for solid wall or ceiling (for High and Extreme version)
<b>FB19041</b>	Kit for recessed mounting in hollow wall or ceilings
<b>FB19049</b>	Kit for recessed mounting in hollow wall or ceilings (for High and Extreme version)
<b>RA03</b>	Additional battery to double the power (NiMH 3.6V / 1.7 Ah)

**Please order additional accessories separately**

Order code	Description
<b>FB12194</b>	Wire guard



# Formula65

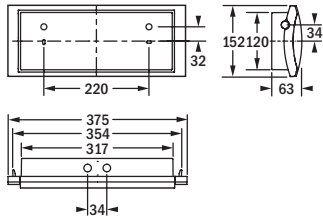

surface wall mounting

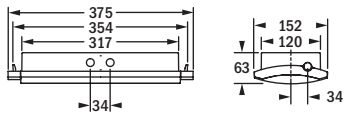

surface ceiling mounting

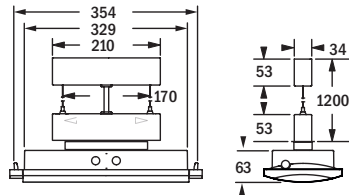

for wire suspension

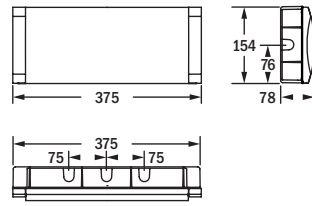
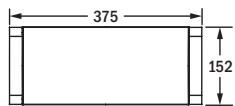

recessed wall mounting  
solid walls

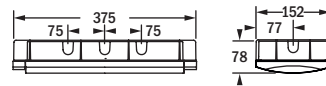

recessed ceiling mounting  
solid ceilings

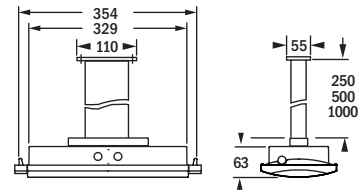

for suspension rod

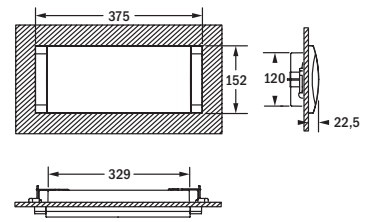
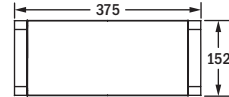

recessed wall mounting  
hollow walls

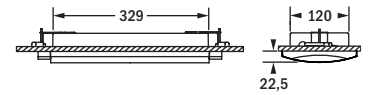

recessed ceiling mounting  
hollow ceilings

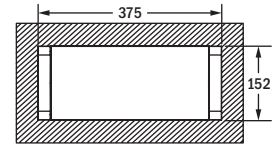

# Formula65 High and Extreme

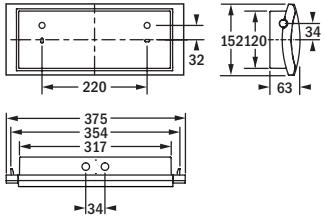

surface wall mounting

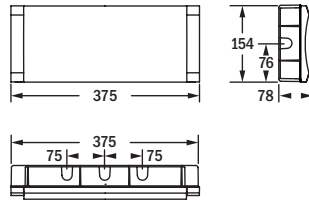

recessed wall mounting  
solid walls

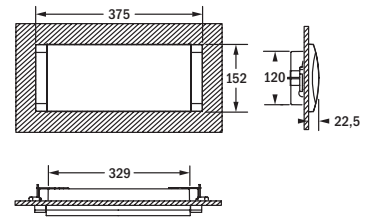

recessed wall mounting  
hollow walls

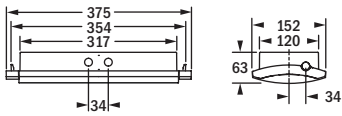

surface ceiling mounting

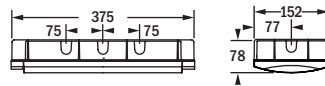

recessed ceiling mounting  
solid ceilings

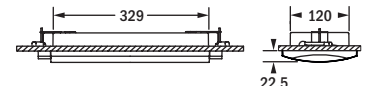

recessed ceiling mounting  
hollow ceilings

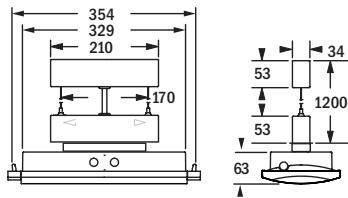
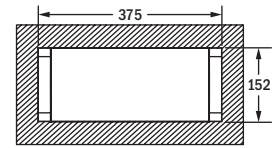
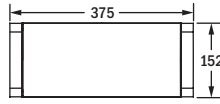
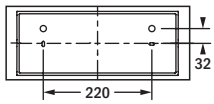

for wire suspension

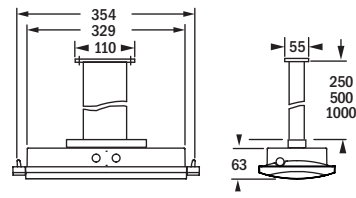

for suspension rod

