



GENERAL SPECIFICATION

- Power** 10, 20, 30, 50 W
- Supply** 220/240 VAC - 50/60 Hz
- Conformity to** EN60598-1; EN60598-2-1; EN 62471
- Protection degree** IP65
- Ambient temp.** -20°C +40°C
- Mounting** Ground or wall
- Body** Die cast aluminium (Bright grey RAL 9006)
- Reflector** Anodized aluminium
- Screen** Tempered high transparency glass
- Power supply** Integrated, Electronic
- Light source** COB LED
- Colour temperature** 4000K
- Life** 35000 h <sup>φ</sup>

# SEF LED

## Outdoor floodlight

Save Energy Flood LED is an outdoor floodlight with body made of aluminium and a polished diffusing reflector.

The screen is made of tempered high transparency glass and the junction box allows the wiring of the fixture without disassembling the light source compartment. This grants a fast and safe installation without endangering the protection degree of the fixture.

SEF LED is available also with integrated movement and twilight sensor.

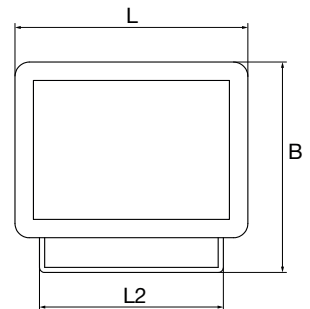
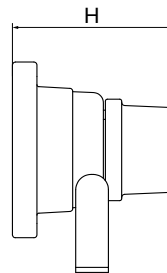
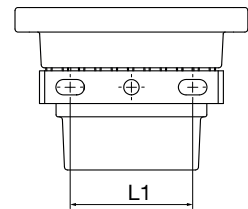

| Power<br>W | • Dimension (mm) • |     |     |     |     | Weight<br>kg |
|------------|--------------------|-----|-----|-----|-----|--------------|
|            | L                  | B   | H   | L1  | L2  |              |
| 10         | 114                | 85  | 85  | 60  | 98  | 0,5          |
| 20         | 180                | 138 | 104 | 94  | 156 | 1,0          |
| 30         | 225                | 185 | 130 | 146 | 200 | 1,7          |
| 50         | 283                | 234 | 150 | 140 | 245 | 2,6          |

## SEF LED REPLACES



**10W**  
50W halogen fixtures



**20W**  
100W halogen fixtures



**30W**  
150W halogen fixtures



**50W**  
200W halogen fixtures

## SEF LED

| W  | Part #      | Description            | EAN code      | Power W | Colour temp. | Ra  | Flux (lm) | Lighting efficiency (lm/W) | Energy Class | Packaging single/multi |
|----|-------------|------------------------|---------------|---------|--------------|-----|-----------|----------------------------|--------------|------------------------|
| 10 | <b>8614</b> | SEF LED IP65 10W 4000K | 8002219506535 | 11      | 4000K        | >70 | 900       | 82                         | A+           | 1/16                   |
| 10 | <b>8617</b> | SEF LED IP65 10W 2700K | 8002219810250 | 11      | 2700K        | >70 | 850       | 77                         | A+           | 1/16                   |
| 20 | <b>8615</b> | SEF LED IP65 20W 4000K | 8002219506542 | 21      | 4000K        | >70 | 1900      | 90                         | A+           | 1/8                    |
| 30 | <b>8616</b> | SEF LED IP65 30W 4000K | 8002219506559 | 32      | 4000K        | >70 | 2650      | 83                         | A+           | 1/8                    |
| 50 | <b>8622</b> | SEF LED IP65 50W 4000K | 8002219713285 | 52      | 4000K        | >70 | 4200      | 81                         | A+           | 1/4                    |

## SEF LED SENSOR

| W  | Part #       | Description                 | EAN code      | Power W | Colour temp. | Ra  | Flux (lm) | Lighting efficiency (lm/W) | Energy Class | Packaging single/multi |
|----|--------------|-----------------------------|---------------|---------|--------------|-----|-----------|----------------------------|--------------|------------------------|
| 10 | <b>8614S</b> | SEF LED IP65 10W 4000K SENS | 8002219713919 | 11      | 4000         | >70 | 900       | 82                         | A+           | 1/16                   |
| 10 | <b>8617S</b> | SEF LED IP65 10W 2700K SENS | 8002219713926 | 11      | 2700         | >70 | 850       | 77                         | A+           | 1/16                   |
| 20 | <b>8615S</b> | SEF LED IP65 20W 4000K SENS | 8002219713933 | 21      | 4000         | >70 | 1900      | 90                         | A+           | 1/8                    |
| 30 | <b>8616S</b> | SEF LED IP65 30W 4000K SENS | 8002219713940 | 32      | 4000         | >70 | 2650      | 83                         | A+           | 1/8                    |
| 50 | <b>8622S</b> | SEF LED IP65 50W 4000K SENS | 8002219713957 | 52      | 4000         | >70 | 4200      | 81                         | A+           | 1/4                    |

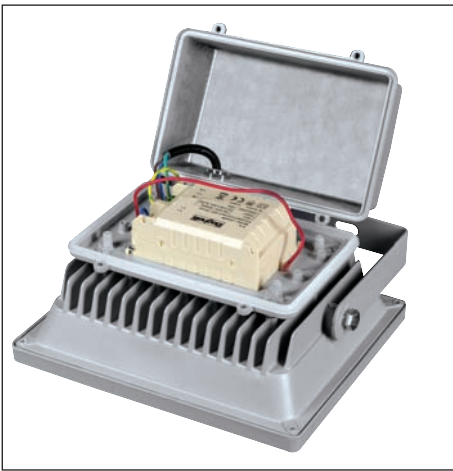

**Quick wiring  
with junction box separated  
from the light source compartment**



**Automatic switching  
by the movement  
and twilight**

**PART NUMBER 8616**

**30W**

