

# Pluraluce

**Emergency luminaire:** Flat design casing in sheet steel and Polycarbonate cover. High-power LED with lighting control through special lenses for asymmetrically-emitted light distribution (illumination of paths with 1 lx), symmetrically emitted light distribution (illumination of surfaces with 0.5 lx) and 1-sided asymmetrically-emitted light distribution (illumination of safety device with 5 lx).

Versions for recessed ceiling mounting.



## Mounting types



### Technical data

Mounting options: recessed ceiling mounting

Body: sheet steel

Cover: polycarbonate, white (RAL 9010)<sup>1/2/3</sup>

Lens: methacrylate, clear

<sup>1</sup> Cover in other colours on request

<sup>2</sup> Square cover for recessed ceiling mounting (RAL 9003) please order separately

<sup>3</sup> Stainless steel round cover for recessed ceiling mounting please order separately

### Decentralized supply

Protection class: III

Mains supply:  
24 V +/- 20% DC

Battery supply:  
24 V +/- 20% DC

Ambient temperature:  
-10 to +40 °C

### Central supply

Protection class: I

Mains supply:  
198V-254V/50Hz

Battery supply:  
EVG: 110V - 276V  
Sleb/Alog: 176V - 276V

Ambient temperature:  
-10 to +40 °C

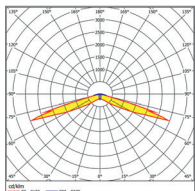

asymmetric  
wide beam

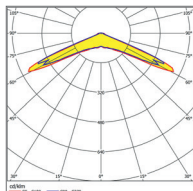

symmetric  
wide beam to 3.5m

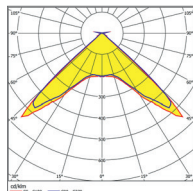

symmetric  
wide beam to 7m

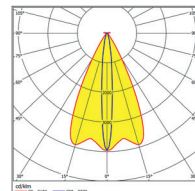

asymmetric  
deep beam

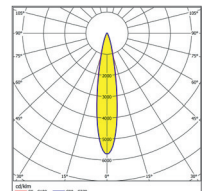

symmetric  
deep beam

### Decentralized / Central supply

SICURO S24	[EVG]	[SLEB]	[ALOG]		LED	P	Φ		P =		S ~	P =
Recessed ceiling mounting suitable for escape route lighting												
TB16763-S24	TB16755	TB16761	TB16763		1	2.5W	218lm		3.8W		6.0VA / 5.0W	
TB16757-S24 <sup>1</sup>	-	-	-		1	2.5W	218lm		3.8W		6.0VA / 5.0W	
Recessed ceiling mounting suitable for area lighting with 2 changeable lenses												
TB16762-S24	TB16754	TB16760	TB16762		1	2.5W	238lm		3.8W		6.0VA / 5.0W	
TB16756-S24 <sup>1</sup>	-	-	-		1	2.5W	238lm		3.8W		6.0VA / 5.0W	

<sup>1</sup> Mounting of exit sign luminaires on or in fire walls resp. fire ceilings with the fire resistance class F30 or F90 according to DIN 4102-4.

Order code	Description
<b>F95807</b>	Narrow beam lens for surface / recessed ceiling mounted luminaires (area lighting) for escape route lighting at mounting heights > 7.5 m
<b>F95808</b>	Narrow beam lens for surface / recessed ceiling mounted luminaires (area lighting) for area lighting at mounting heights > 7.5 m
<b>F95815</b>	Asymmetrical lens for surface / recessed ceiling mounted luminaires (area lighting) for illumination of the safety devices with 5lx

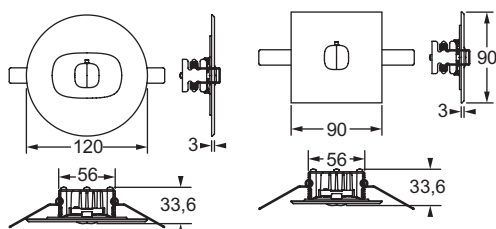
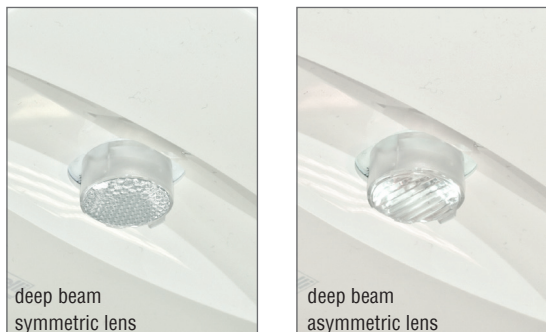

ceiling cutout:  
80 mm diameter  
ceiling plate: 2 mm - 15 mm

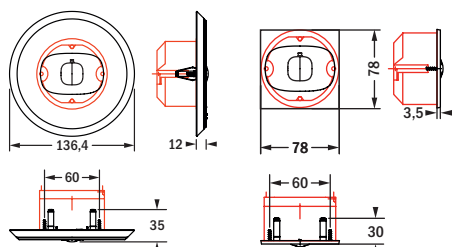

recessed ceiling mounting (ds)<sup>1</sup> in F30 / F90 box  
(shown in red)

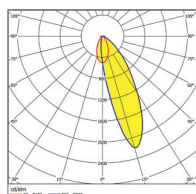
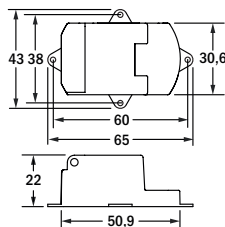

1-sided  
asymmetric

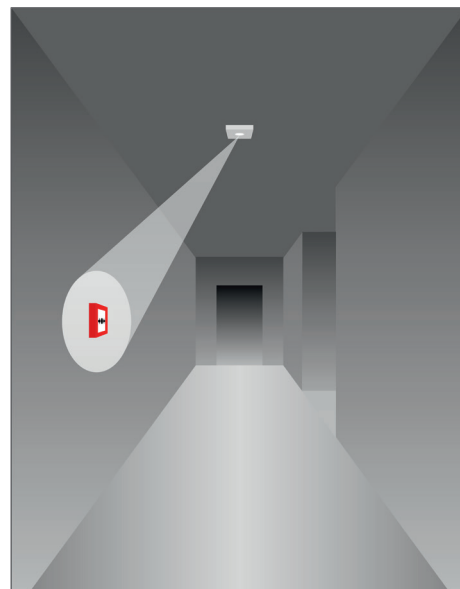
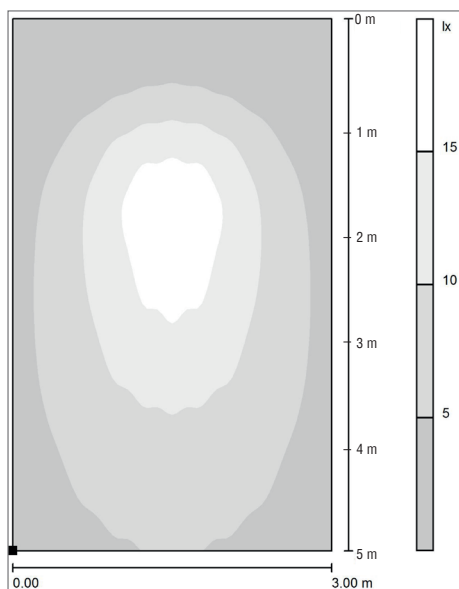

Order code	Description
F95812	Sheet steel square cover, white RAL 9010 (escape route lighting)
F95811	Sheet steel square cover, white RAL 9010 (area lighting)
F95814	Square cover in sheet steel for installation boxes (ds), white RAL 9010 (escape route lighting)
F95813	Square cover in sheet steel installation boxes (ds), white RAL 9010 (area lighting)
F95804	Stainless steel round cover (escape route lighting)
F95803	Stainless steel round cover (area lighting)

<sup>1</sup> cs= central supply ds = decentralized supply