



DOT

Downlight with housing made of sheet steel and cover in high type of protection made of polyhydroxyalkanoate (PHA), a biopolyester overpaintable with wall paint. One pair of high-power LEDs with light guidance through special lenses. Double optic in one luminaire – through a simple turn of the high-power LEDs either asymmetrical shining light distribution (illumination of escape routes with 1 lx) or symmetrical shining light distribution (illumination of areas with 0.5 lx). Laser module Orma for subsidiary escape route indication (only in emergency operation) through projection of an arrow symbol on the floor for version LIFE available as accessory.

Version for recessed ceiling mounting

MOUNTING TYPES



TECHNICAL DATA

| | |
|--|--|
| Housing: | Sheet steel, white (RAL 9010) |
| Cover: | PHA, white (RAL 9003) |
| Lenses: | PMMA, transparent |
| Type of protection: | IP65 (cover) IP20 (backside, equipment housing) |
| Service life $L_{80B_{20}}$: | 50.000 h |

| | |
|-------------------------------|---------|
| Color stability: | 3 SDCM |
| Color temperature: | 4.000 K |
| Color rendering index: | 70 |
| Optic interface: | LIFE |



Commissioning - LIFE: For Autotest, operating duration, operating mode PS, monitoring group and test duration are only programmable per app B.connect over smartphone locally on luminaire.

SELF-CONTAINED SUPPLY

| | |
|-----------------------------|--|
| Mains supply: | 198 V – 254 V/50 Hz |
| Switching: | Maintained and non-maintained or non-maintained |
| Ambient temperature: | LIFE: -10 °C to +45 °C LIFE ECO: 0 °C to +40 °C |
| Protection class: | I |

DECENTRAL SUPPLY

| | |
|-----------------------------|------------------|
| Mains supply: | 24 V +/- 20 % DC |
| Battery supply: | 24 V +/- 20 % DC |
| Ambient temperature: | -20 °C to +40 °C |
| Protection class: | III |

CENTRAL SUPPLY

| | |
|-------------------------------|-------------------------|
| Mains supply: | 198 V – 254 V/50 Hz |
| Battery supply: | 176 V – 276 V |
| Ambient temperature: | -20 °C to +40 °C |
| Protection class: | I |
| Mains supply (alt.): | 90 V – 254 V / 50/60 Hz |
| Battery supply (alt.): | 90 V – 276 V |

| Variant |  |
|-----------------------------|---|
| LIFE | 240 lm |
| LIFE ECO | – |
| Sicuro24 / Sicuro230 | 550 lm |

FORMULAS FOR CALCULATION OF THE RESPECTABLE LIGHT FLUX IN MAINS AND BATTERY OPERATION

Ideational light flux of luminaire in mains operation [%] = 100 %

Respectable light flux of luminaire in mains operation [lm] =

$$\text{Respectable light flux of luminaire in mains operation [\%]} \times \frac{\text{Ideational light flux of luminaire in mains operation [lm]}}{100 \%}$$

Ideational light flux of luminaire in battery operation [%] = 100 %

Respectable light flux of luminaire in battery operation [lm] =

$$\text{Respectable light flux of luminaire in battery operation [\%]} \times \frac{\text{Ideational light flux of luminaire in battery operation [lm]}}{100 \%}$$

LIFE SELF-CONTAINED SUPPLY

10 YEARS
GUARANTEE

| Autotest / CableCom Order code | Logica Order code | Logica FM Order code | LED | $\Phi=$ ⁴ 1 h | $\Phi=$ ⁴ 3 h | $\Phi=$ ⁴ 8 h | | S~ |
|-----------------------------------|--------------------------|--------------------------|-----|-----------------------------|-----------------------------|-----------------------------|---------------------|------|
| 19711 | 19711+15036 ¹ | 19711+15037 ¹ | 2 | 550 lm | 200 lm | 100 lm | LIFE 6.4 V / 1.5 Ah | 8 VA |

Recessed ceiling mounting for escape route and area illumination

LIFE ECO SELF-CONTAINED SUPPLY

5 YEARS
GUARANTEE

| Autotest Order code | Logica Order code | Logica FM Order code | LED | $\Phi=$ ⁴ 1 h | $\Phi=$ ⁴ 3 h | $\Phi=$ ⁴ 8 h | | S~ |
|------------------------|----------------------|----------------------------|-----|-----------------------------|-----------------------------|-----------------------------|----------------------|---------|
| 19712 ³ | 19712 ³ | 19712+19375 ^{2,3} | 2 | 1.000 lm | 400 lm | 150 lm | LIFE 12.8 V / 1.5 Ah | 12.5 VA |

Recessed ceiling mounting for escape route and area illumination





SICURO[®] DECENTRAL SUPPLY

| Sicuro24 Order code | LED | $\Phi=$ ⁴ | P= |
|------------------------|-----|----------------------|-------|
| 17881 | 2 | 550 lm | 4.1 W |

Recessed ceiling mounting for escape route and area illumination

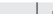
¹ Please order Logica interface (15036) and Logica FM interface (15037) separately.
² Please order Logica FM interface (19375) separately.
³ With LIFE ECO inverter module 19391, only for non-maintained mode.
⁴ Ideational light flux of 100 %. Corresponds to no adjustable / programmable value.

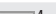
SICURO[®] CENTRAL SUPPLY

| | | | | |
|--|--|---|---|---|
| Sicuro230 Order code |  |  |  |  |
| Recessed ceiling mounting for escape route and area illumination | | | | |
| 17880 | 2 | 550 lm | 9.4 VA / 4.7 W | |

Recessed ceiling mounting for escape route and area illumination

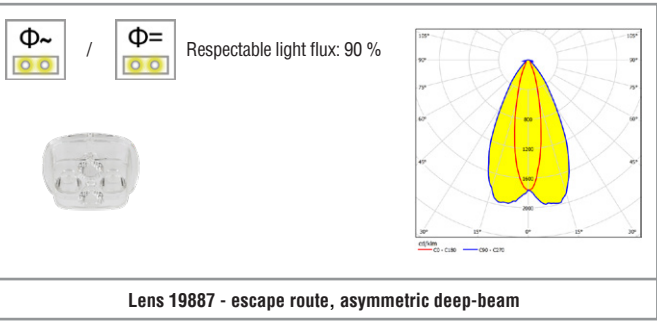
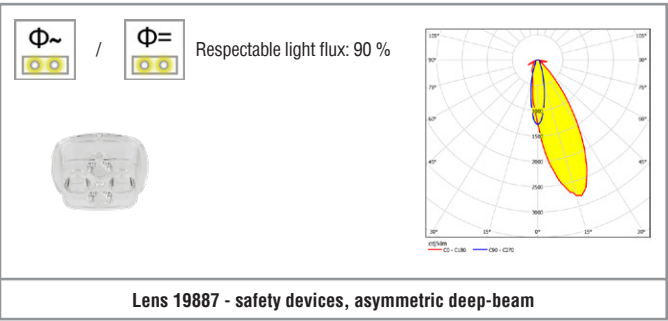
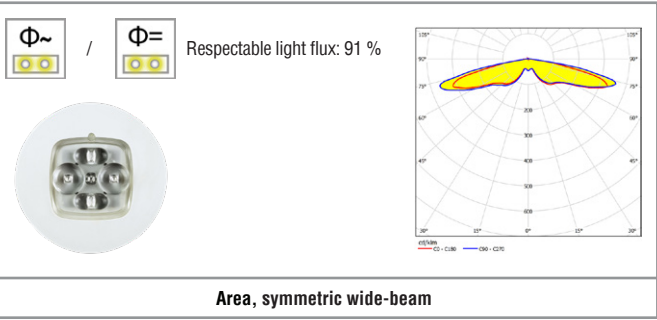
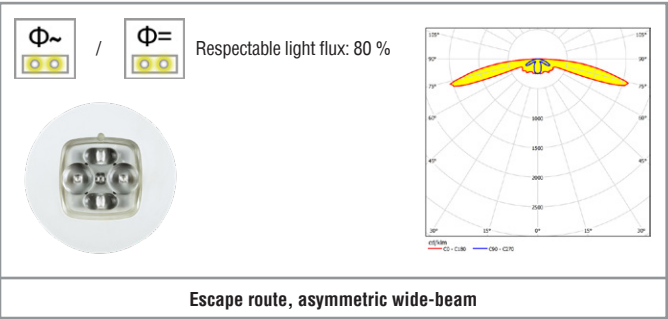

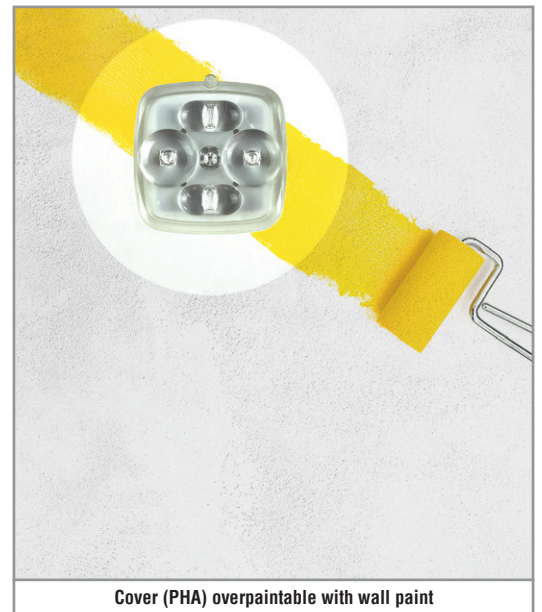
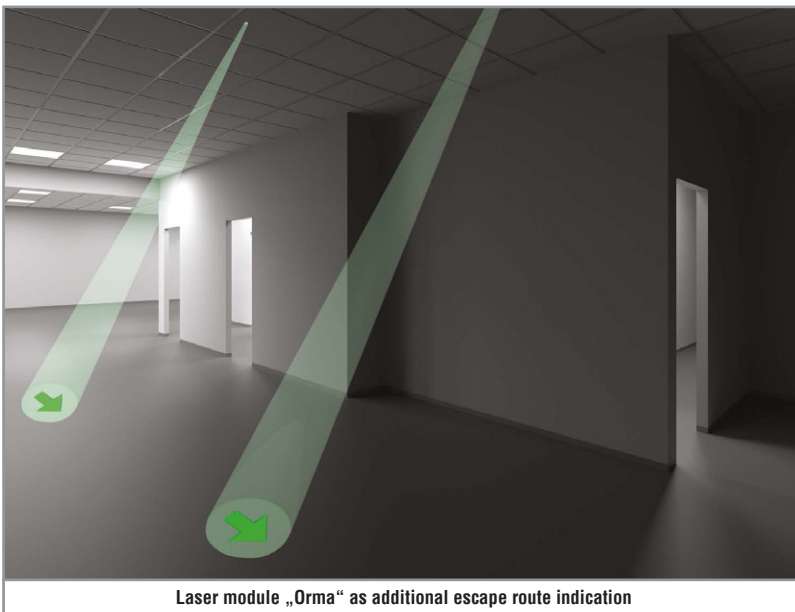
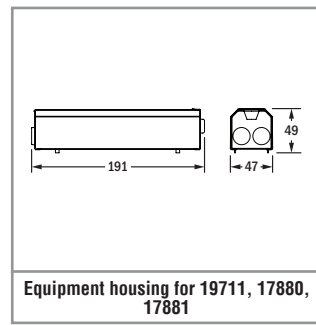
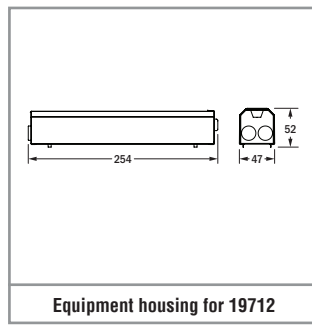
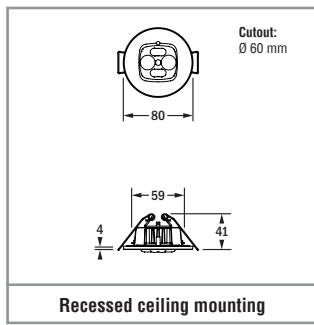

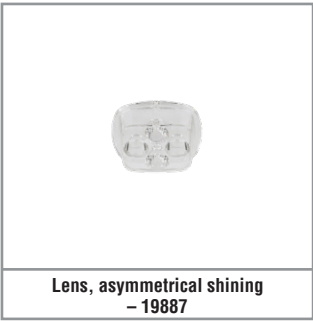

Lens, asymmetrical shining
– 19887

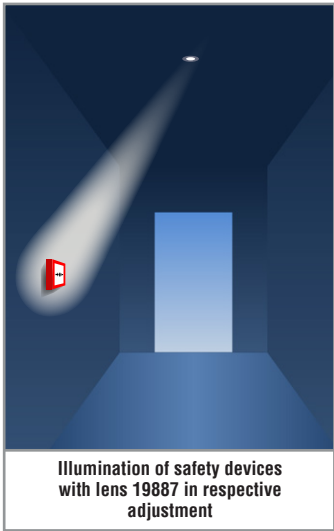

Illumination of safety devices
with lens 19887 in respective
adjustment

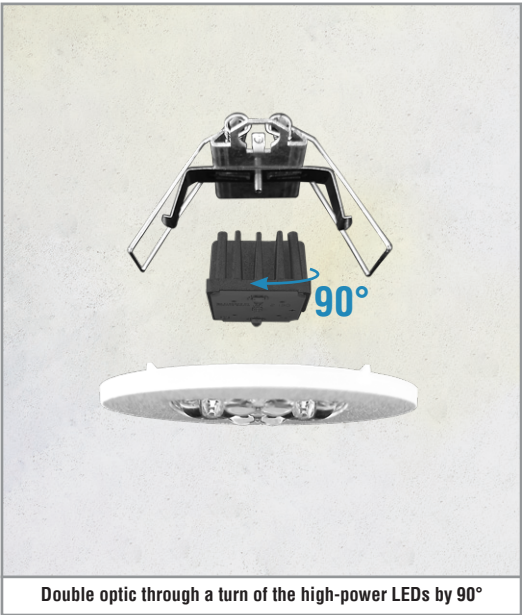

Double optic through a turn of the high-power LEDs by 90°

| Please order accessories separately | |
|-------------------------------------|--|
| Order code | Description |
| 15036 | Logica interface for 19711 |
| 15037 | Logica FM interface for 19711 |
| 15038 | DALI interface for 19711 (for connection to DALI central of the general and safety lighting) |
| 19375 | Logica FM interface for 19712 |
| 19883 | Laser module Orma for 19711 |
| 19887 | Asymmetrical shining lens for illumination of safety devices with 5 lx as well as for illumination of escape routes with 1 lx at mounting heights of 7 m (through turn of the high-power LEDs) |