

Formula 65 LED AT GL



ta 0÷40°C

230V-50Hz

CE IP65

Beghelli

CSQ ISO 14001

CSQ ISO 9001

IoNet

www.beghelli.com

BEGHELLI S.p.A. - Via Mozzeghine 13/15 - località Monteveglio 40053 Valsamoggia (BO) ITALY - Tel. +39 051 9660411 - Fax +39 051 9660444 - N° Verde 800 626626

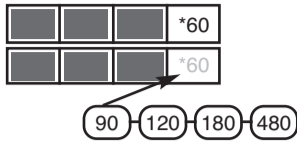
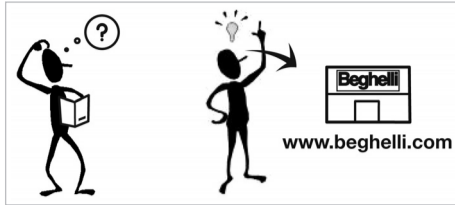

A

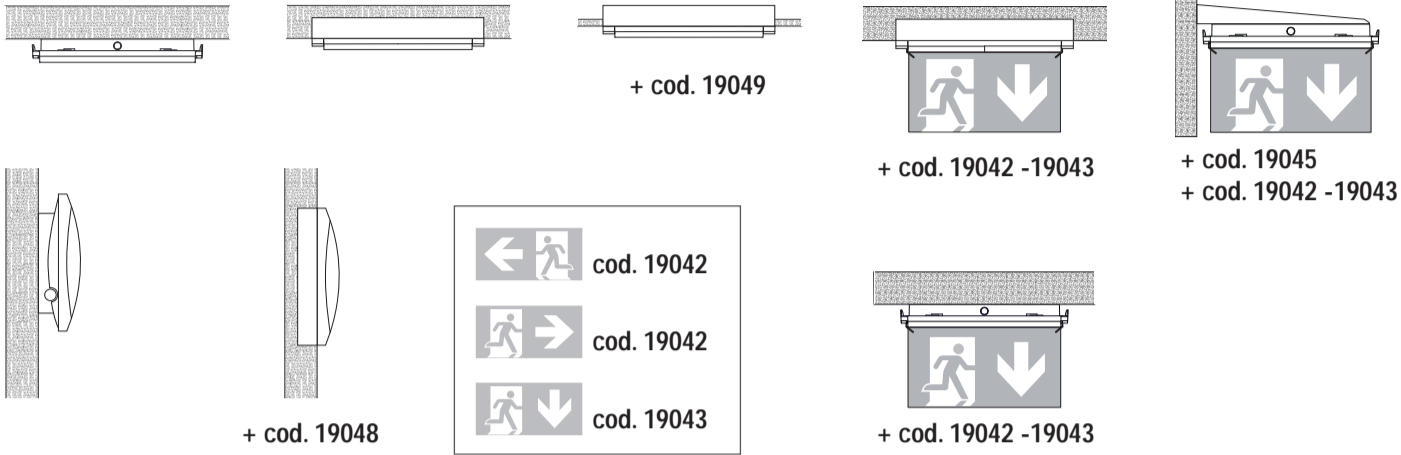

B

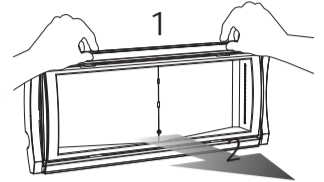

C

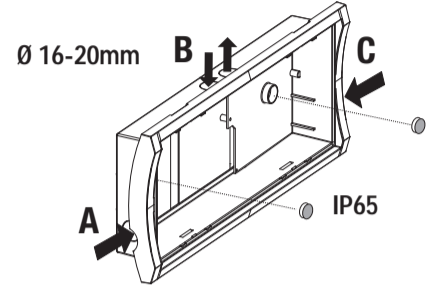

D

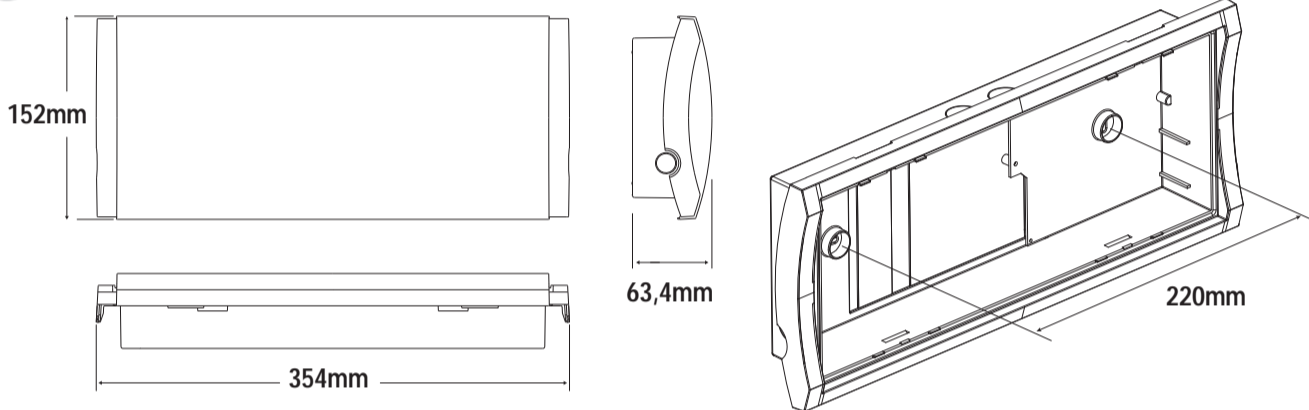

E

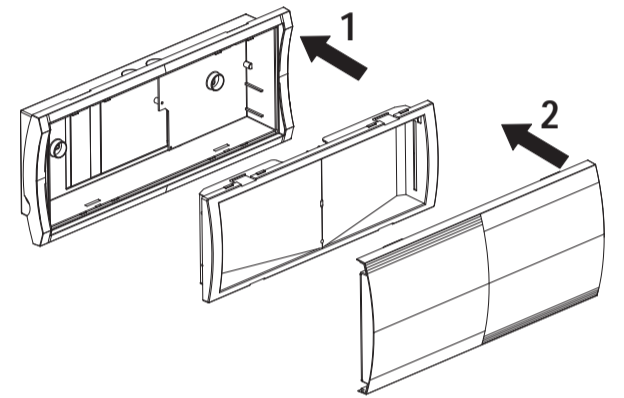

F

Settaggio base (1h-3h) senza uso di App
Basic setting (1h-3h) without using App

1

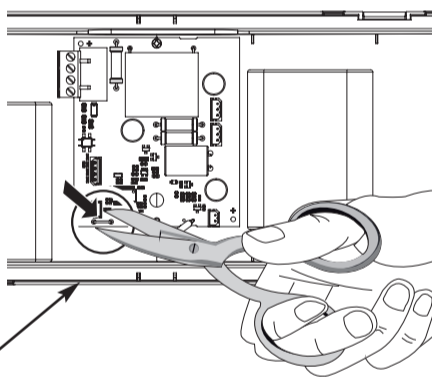

- Autonomia:**
- 1h filo integro
 - 3h filo tagliato
- Autonomy:**
- 1h wire intact
 - 3h cut wire



Connettere la batteria DOPO il taglio del filo per la selezione dell'autonomia
La selezione dell'autonomia della lampada effettuata da App è prioritaria rispetto alle impostazioni sul circuito.

Connect the battery AFTER cutting the wire for autonomy selection
The selection of the autonomy of the lamp made by the App has priority over the settings on the circuit.

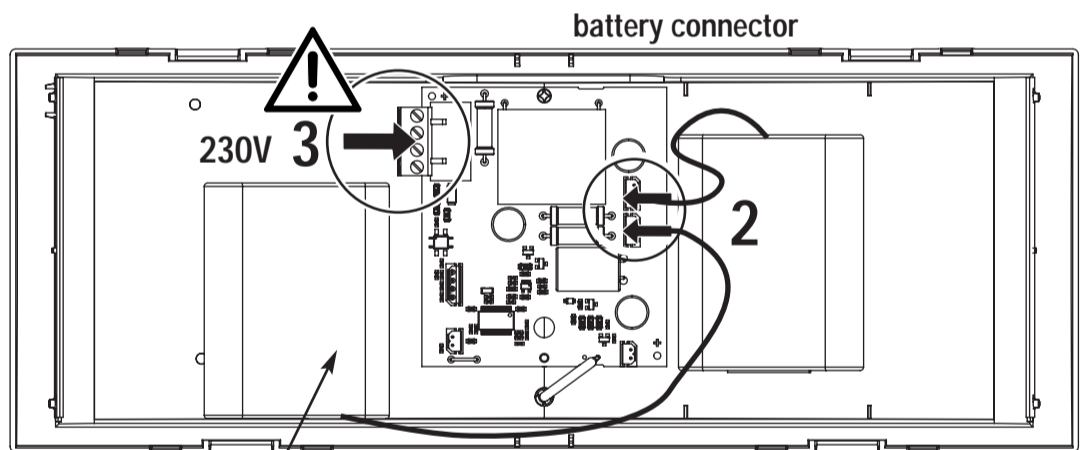

OPTIONAL RA 06
LiFe 9,6V 1,5Ah



La selezione dell'autonomia della lampada effettuata da App è prioritaria rispetto alle impostazioni sul circuito.

The selection of the autonomy of the lamp made by the App has priority over the settings on the circuit.

SA lamp

SE lamp

SA

SA

SE

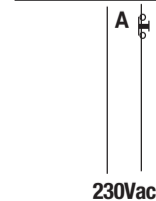
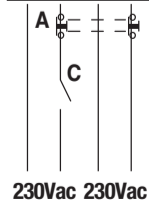
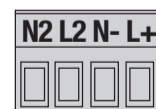
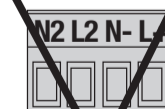
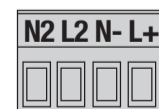

A= Test

C= Interruttore accensione lampada/ Light switch

