

Mounting instructions

Series 86 Atomic

230V/50Hz

BEGHELLI - ELPLAST, a.s.
Poříčí 3A, 603 16 Brno - CZ
Tel: (+420) 531 014 111
Fax: (+420) 531 014 210
beghelli@beghelli.cz, www.beghelli.cz



DIMENSIONS

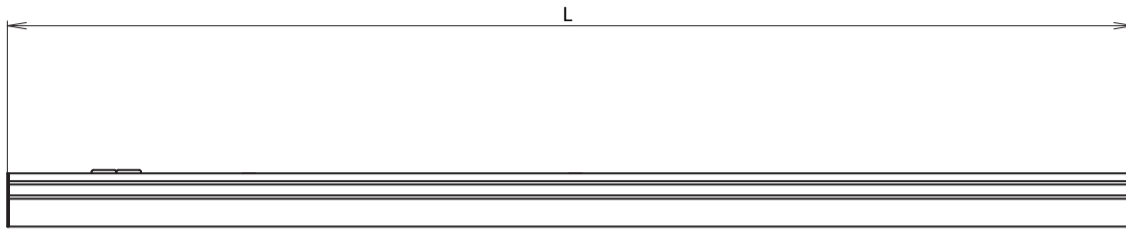

TYPE:	L	B	H	X
86-003/114	583	60	56	61
86-003/124	583	60	56	61
86-003/121	883	60	56	61
86-003/139	883	60	56	61
86-003/128	1183	60	56	61
86-003/154	1183	60	56	61
86-003/135	1483	60	56	61
86-003/180	1483	60	56	61

L - LENGTH INCLUDING ENDINGS

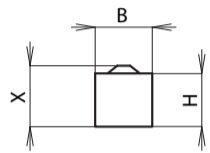

X - ONLY FOR SURFACE MOUNTED VERSIONS



IMAGE - 1



IMAGE - 2



IMAGE - 3

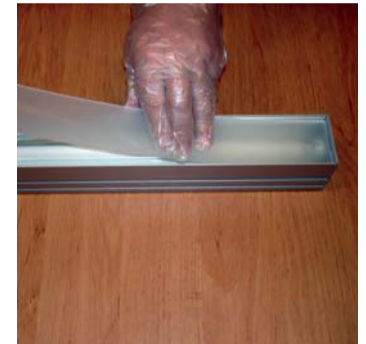
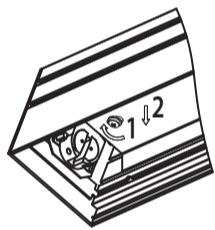

IMAGE - 4

MOUNTING PROCEDURE

1) REMOVING REFLECTOR



2) PREPARATION OF A SCREW AND DIST. INSERTIONS

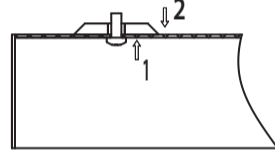

3) MOUNTING HOLES

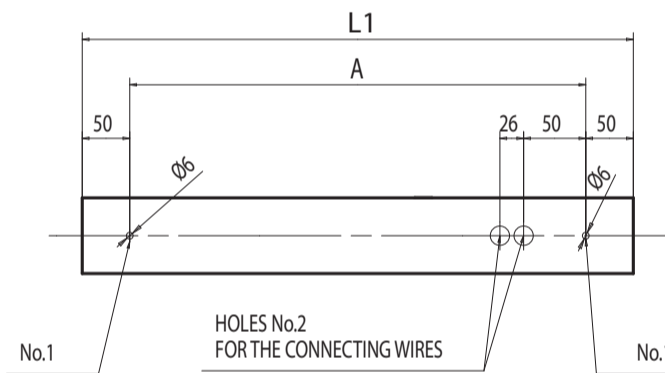

TYPE:	L1	A
86-*/*/114	580	480
86-*/*/124	580	480
86-*/*/121	880	780
86-*/*/139	880	780
86-*/*/128	1180	1080
86-*/*/154	1180	1080
86-*/*/135	1480	1380
86-*/*/180	1480	1380

L1 - LENGTH EXCLUDING ENDINGS

HOLES No.1 - FOR MOUNTING:
ON WALL/CEILING, SUSPENDED MOUNTING, MOUNTING ON RECESSED FRAME
HOLES No.1 DIAMETER

4) PREPARATION OF CONNECTING PART



5) MOUNTING OF ENDING

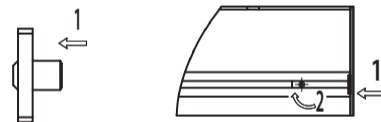

6) FITTING COUPLING PART TO PROFILE

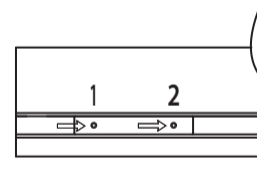

7) LUMINAIRE CONNECTION WITH COUPLING PART

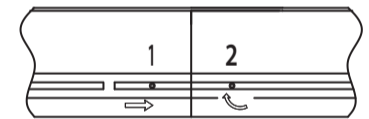

8) ASSEMBLY OF HINGE ON LUMINAIRE

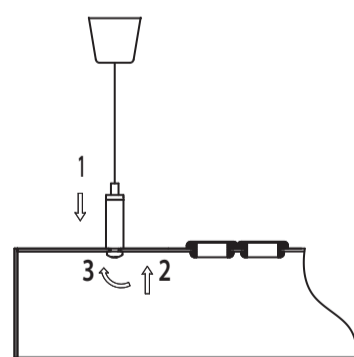

9) MOUNTING HOLE

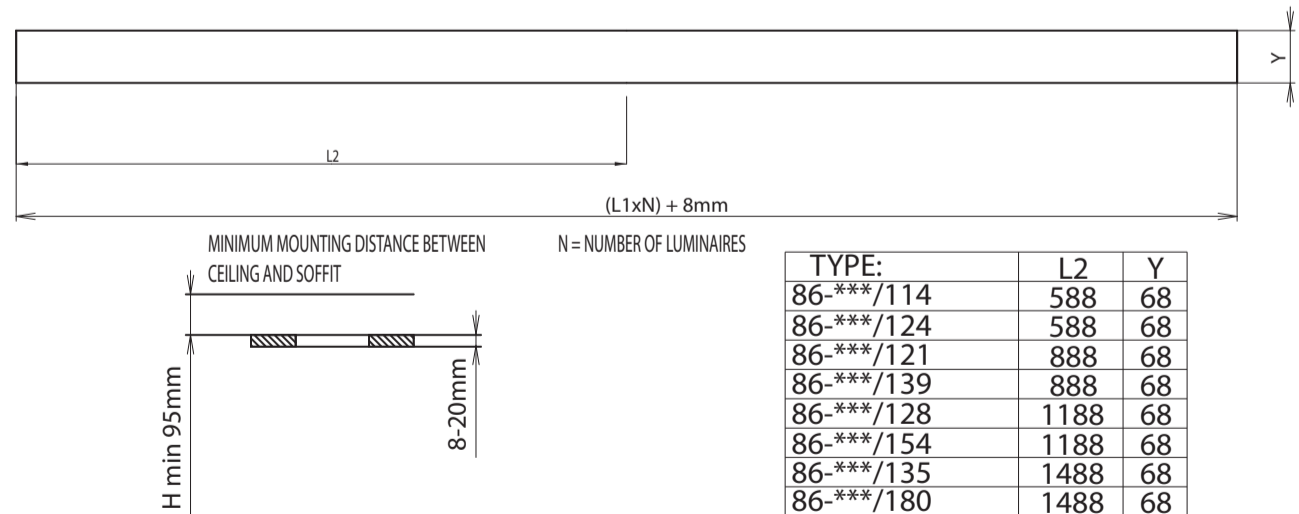

TYPE:	L2	Y
86-*/*/114	588	68
86-*/*/124	588	68
86-*/*/121	888	68
86-*/*/139	888	68
86-*/*/128	1188	68
86-*/*/154	1188	68
86-*/*/135	1488	68
86-*/*/180	1488	68

10) ASSEMBLY OF RECESSED FRAME

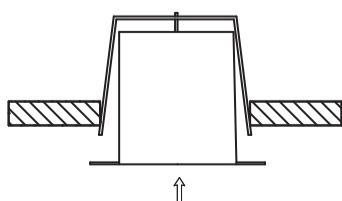

11) MOUNTING OF ENDING

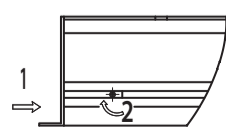

12) LUMINAIRE ASSEMBLY INTO RECESSED FRAME

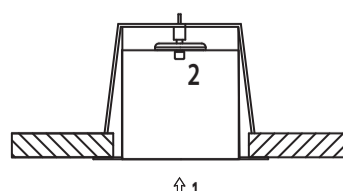

13) CLUTCH ASSEMBLY

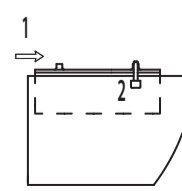

14) CONNECTION FRAME

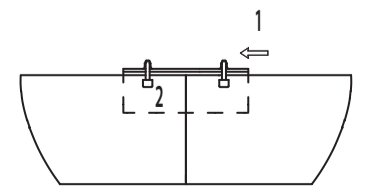

Mounting instructions

Series 86 Atomic

   230V/50Hz

BEGHELLI - ELPLAST, a.s.
Poříčí 3A, 603 16 Brno - CZ
Tel: (+420) 531 014 111
Fax: (+420) 531 014 210
beghelli@beghelli.cz, www.beghelli.cz



MOUNTING PROCEDURE:

86-003 – CEILING MOUNTING (separate)

Remove the louvre/cover (see IMAGE-1) and the reflector (Fig.1) from the luminaire. Lead the wire through the hole for the cable. Prepare the screw and the insertion (Fig.2). Attach the luminaire with screws into pre-drilled holes (Fig.3) and connect the cables to the terminal located on the beam. Assembly the reflector in reverse order than shown in the Fig.1. Place the lamps T5 into the sleeves and mount back the louvre/cover (see IMAGE-2).

86-013 – CEILING MOUNTING (coupling in lines)

Remove the louvre/cover (see IMAGE-1) and the reflector (Fig.1) from the luminaire. Then prepare the clutch (Fig.4) and assembly the ending 99-0101 on the first and the last luminaire in the line (Fig.5). Then assembly the clutch into profile (Fig.6). Pass the wire through the hole. Prepare the screw and the insertion (Fig.2). Attach the luminaires with screws into pre-drilled holes (Fig.3) and connect them to each other (Fig.7). Lead the power cable to the terminal box located on the beam and then interconnect all the luminaires with wire required length and corresponding cross-section. Assembly the reflector in reverse order than shown in the Fig.1. Place the lamps T5 into the sleeves and mount back the louvre/cover (see IMAGE-2).

86-003 – PENDANT MOUNTING (separate)

Remove the louvre/cover (see IMAGE-1) and the reflector (Fig.1) from the luminaire. Assembly the pendant 99-0085 into pre-drilled holes (Fig.3). Attach the luminaire to pendant 99-0085 with screws M4 (Fig.8). Lead the power cable the hole and connect it to the terminal block located on the beam. Assembly the reflector in reverse order than shown in the Fig.1. Place the lamps T5 into the sleeves and mount back the louvre/cover (see IMAGE-2).

86-013 – PENDANT MOUNTING (coupling in lines)

Remove the louvre/cover (see IMAGE-1) and the reflector (Fig.1) from the luminaire. Then prepare the clutch (Fig.4) and assembly the ending 99-0101 on the first and the last luminaire in the line (Fig.5). Then assembly the clutch into profile (Fig.6). Assembly pendants 99-0096 into pre-drilled holes (Fig.3). Attach the luminaires to pendant 99-0096 by screws M4 (Fig.8) and connect them to each other (Fig.7). Pass the wire 99-0094 or 99-0095 through the hole and plug in the terminal box located on the beam. Then interconnect all the luminaires with wire required length and corresponding cross-section. Assembly the reflector in reverse order than shown in the Fig.1. Place the lamps T5 into the sleeves and mount back the louvre/cover (see IMAGE-2).

86-023 – RECESSED MOUNTING (separate)

Remove the louvre/cover (see IMAGE-1) and the reflector (Fig.1) from the luminaire. Attach the recessed frame (Fig.10) into mounting hole (Fig.9) and then expand the springs by tightening the screw in the frame. Attach endings for recessed mounting 99-0102 (Fig.11). Pass the wire through the hole and attach the luminaire to the frame by tightening screws M4 (Fig.12). Lead the power cable through the hole and connect it to the terminal block located on the beam. Assembly the reflector in reverse order than shown in the Fig.1. Place the lamps T5 into the sleeves and mount back the louvre/cover (see IMAGE-2).

86-033 – RECESSED MOUNTING (coupling in lines)

Remove the louvre/cover (see IMAGE-1) and the reflector (Fig.1) from the luminaire. Fit and tighten the coupling on the embedded frame (Fig.13). Attach the recessed frame (Fig.10) into mounting hole (Fig.9) and then connect both frames by clutch (Fig.14). Expand the springs by tightening the screw in the frame. Then prepare the clutch (Fig.4) and assembly into profile (Fig.6). Assembly the ending 99-0102 on the first and the last luminaire in the line (Fig.11). Lead the power cable through the hole. Then attach the luminaires into the frame by tightening screws M4 (Fig.12) and connect them (Fig.7). Plug the power cable into terminal box located on the beam and interconnect all the luminaires with wire required length and corresponding cross-section. Assembly the reflector in reverse order than shown in the Fig.1. Place the lamps T5 into the sleeves and mount back the louvre/cover (see IMAGE-2).

For handling louvre and reflector use enclosed gloves.

TECHNICAL DETAILS:

- Rated voltage: 230V, 50Hz
- Light source: linear fluorescent lamp T5
- Degree of protection: IP 20
- Electrical accident protection class: I
- Suitable for direct mounting onto a normally inflammable basis - F: yes
- The luminaire satisfies requirements of all standards in force

WARNING:

- Check whether the mains specification satisfies the data mentioned on a luminaire plate before connecting it to the mains.
- Contact the customer service authorised centre for replacement of fluorescent tubes and batteries and for repairs, and insist on using original spare parts only. Not satisfying these instructions could result in loss of luminaire safety or in loss of warranty.
- This luminaire should only be used for a purpose for which it was manufactured. Any other usage shall be assumed to be unsuitable and therefore dangerous. The manufacturer bears no responsibility for any injury caused to persons or animals or for property damages caused by improper, faulty or inadequate usage.
- A luminaire must be disconnected from the mains before any interference with a luminaire, service or maintenance. An expert person, in terms of valid regulations concerning the competence to activities, should only perform these actions.
- The luminaire may only be connected to the mains, whose installation and protection satisfies standards in force.

WARRANTY:

All products of the company Beghelli - Elplast, a.s. are made of the highest quality materials, thoroughly tested and guaranteed by the manufacturer to be free of defects in terms of existing legislative regulations. This warranty becomes invalid if mounting is not executed according to the instruction manual, the luminaire is damaged or modified or repaired by an unauthorised service centre of the company Beghelli - Elplast, a.s.

The product cannot be disposed as unsorted municipal waste. It must be collected separately to prevent negative environmental impacts. In accordance with the procedures of Directive 2002/96 and relevant national laws and regulations adopted pursuant to this Directive on the disposal of waste at the end of the life cycle of the product, any violation is sanctioned by law. Please inform yourself about the local separate collection system for electrical and electronic products.

